

Appendix A

Beaumont Heights JMS

Floor plan showing the rooms proposed to be leased to the Entry to School Program

Rooms proposed to be leased to Kerry's Place

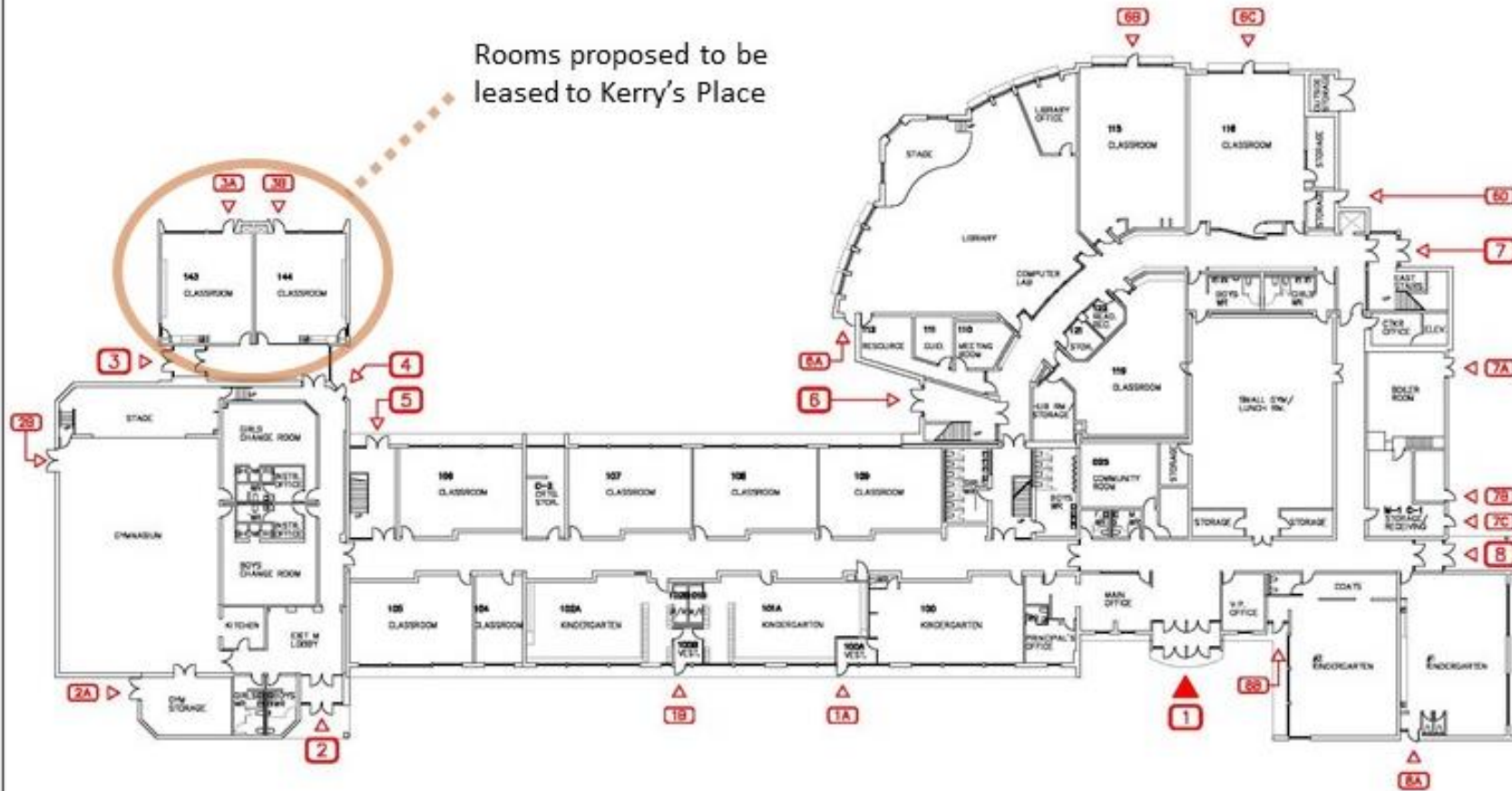

LEGEND:

EX. DOOR LABEL 00000
MAIN ENTRANCE ▼
EXTERIOR DOOR ▼

North Arrow

Facility Services
Toronto District School Board
Technical Services Division
Design & Construction Unit
110 Adelaide Street East, Toronto, Ontario M5H 2T3
416-393-4000 / 416-393-9734

Facility
Beaumont Heights Jr Middle School
Address
70 Monterrey Drive
M9V 1T1
ETOBICOKE

Sheet Title
1st Floor

Facility #
0336
Last Update
2017 Jun 01

Actual enrolment Oct 2021	519
Projected enrolment Oct 2025	480
Building capacity	608
Utilization rate Oct 2021	85%
Utilization rate Oct 2025	79%



Floor plan showing the rooms proposed to be leased to the Entry to School Program

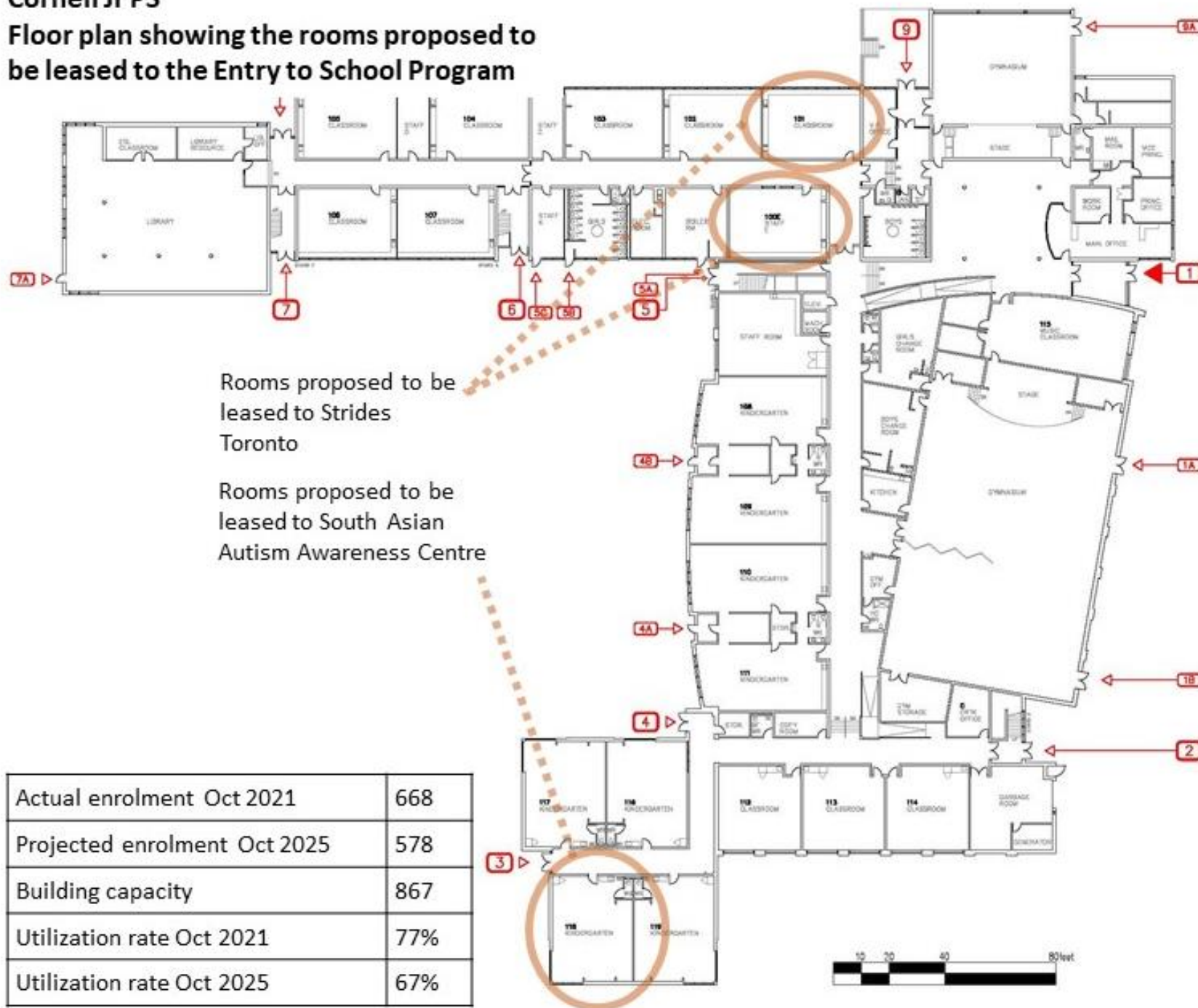

Actual enrolment Oct 2021	668
Projected enrolment Oct 2025	578
Building capacity	867
Utilization rate Oct 2021	77%
Utilization rate Oct 2025	67%

EX. DOOR LABEL	XXXX
MAIN ENTRANCE	▼
EXTERIOR DOOR	▽



Technical Services Division
Design & Construction Unit
15 Orlithwa Cres. Toronto, Ontario M2H 2T5
t. 416-393-4032 / f. 416-393-9734

**Cornell
Jr Public School**
Address
61 Holmfirth Terrace
M1G 1G8
SCARBOROUGH

Sheet Title
4th Floor

Facility #	Last Update
0321	2018Feb01

Appendix A

Emily Carr PS

Floor plan showing the rooms proposed to be leased to the Entry to School Program

Rooms proposed to be leased to South Asian Autism Awareness Centre

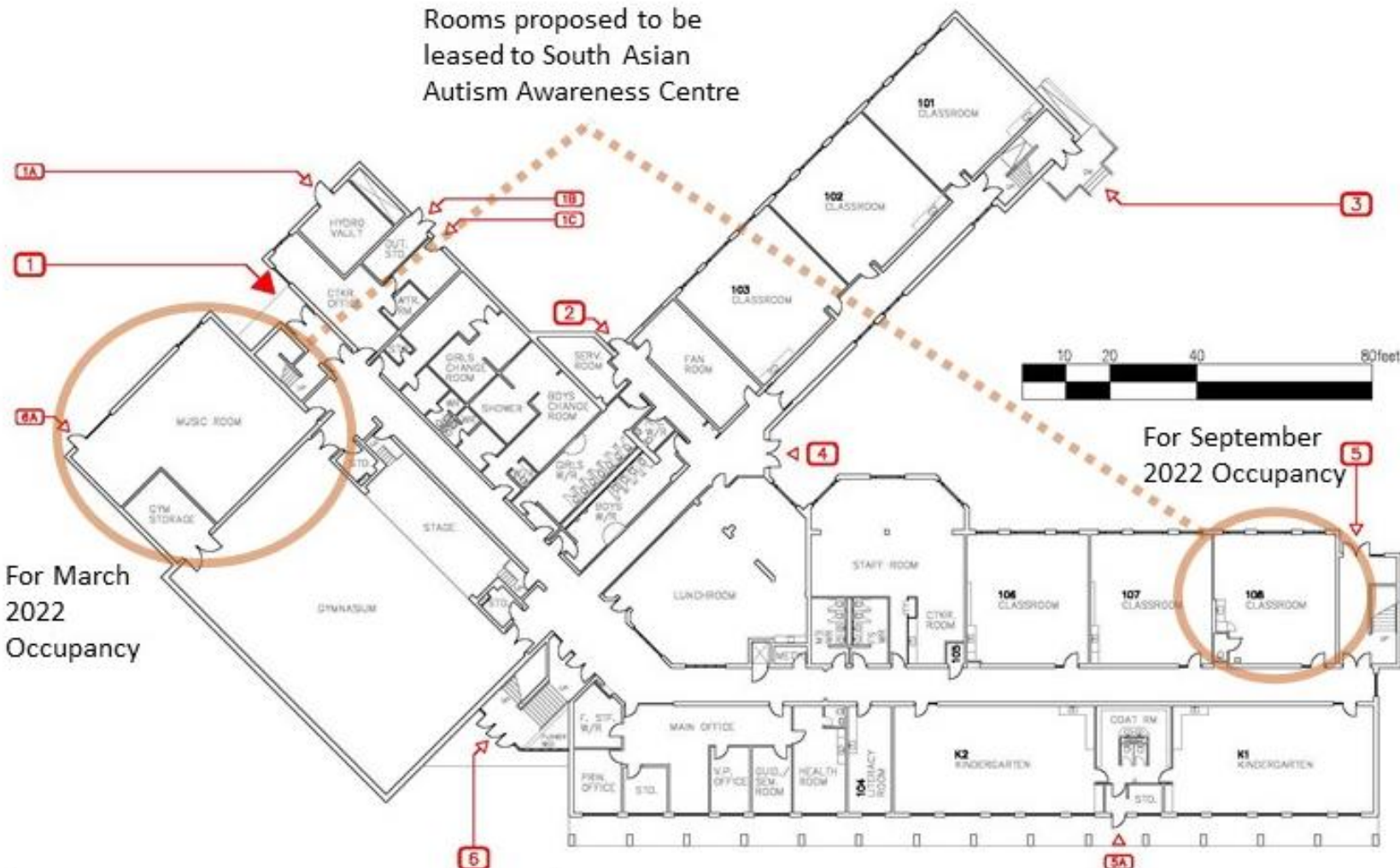

Actual enrolment Oct 2021	289
Projected enrolment Oct 2025	323
Building capacity	429

Utilization rate Oct 2021	67%
Utilization rate Oct 2025	75%

LEGEND:

EX. DOOR LABEL
MAIN ENTRANCE
EXTERIOR DOOR

North Arrow

Facility Services



Technical Services Division
Design & Construction Unit
150 Midland Ave. Toronto, Ontario M2N 2T5
T: 416-393-4088 / F: 416-393-9734

Facility

**Emily Carr
Public School**
Address
90 John Tabor Trail
M1B 2V2
SCARBOROUGH

Sheet Title

1st Floor

Facility #
0349

Last Update
2018Jul01